

## Changing Paper

This topic includes:

- "Guidelines" on page 2-2
- "Tray Setup" on page 2-2

The paper trays use only certain sizes and types of paper or transparencies. For best results, **use only Xerox Phaser Color Printing Media** specified for this printer. They are guaranteed to produce excellent results on your Phaser 6250 Printer – the Phaser 6250 and Phaser media are *Made for Each Other*. See the “Basic Printing” topic later in this section for instructions on how to load paper in the trays.

### Caution

If you change the type of paper in a tray, you **must** change the paper type on the front panel to match the paper that you loaded. **If you fail to do this, print-quality problems can occur and the fuser can be damaged.**

## Guidelines

The trays accommodate only certain sizes and types of paper, transparencies, or other specialty media. After loading a tray, set the correct paper type and/or size at the print's front panel.

- Do not overload the paper tray. See the tray label for the fill line.
- Fan paper, transparencies, or other specialty media before loading in the paper tray.
- If excessive jams occur, use fresh paper, transparencies, or other specialty media from a new package.

### Caution

Damage caused by using unsupported paper, transparencies, and other speciality media is not covered by the Xerox warranty, service agreement, or Total Satisfaction Guarantee.

## Tray Setup

### Note

For optimal print quality and performance, set the correct paper type at the printer's front panel after loading paper in any tray. When loading paper in Tray 1 (MPT), also set the correct paper size.

1. Load paper in the tray.

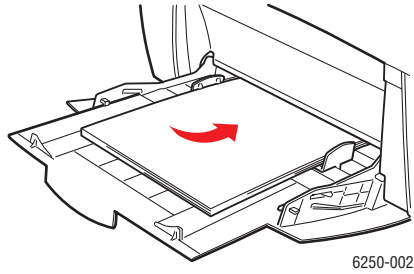

Tray 1 (MPT)

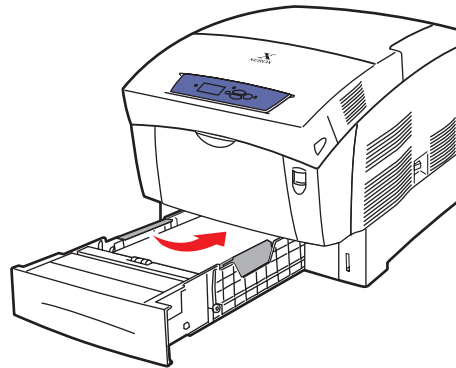

Trays 2-4

When prompted by the front panel to confirm the paper type and size:

2. If you have not changed the type or size of paper, press the **OK** button to accept the current setting for paper type and size.
3. If you have changed the paper type:
  - a. At the printer's front panel, select **Change**, then press the **OK** button.
  - b. Select the appropriate paper type.
  - c. Press the **OK** button to save your selection.
4. If you have changed the paper size:
  - a. Select the appropriate paper size.
  - b. Press the **OK** button to save your selection.

For more information on paper types, weights, and sizes, go to [Reference/Printing/Supported Papers](#) on the *User Documentation CD-ROM*.

For online support information, go to [www.xerox.com/officeprinting/infoSMART](http://www.xerox.com/officeprinting/infoSMART).